

TRINITY LUTHERAN HIGH SCHOOL SEYMOUR, INDIANA

A CASE FOR SUPPORT Built on a Firm Foundation!



THE TRINITY LEGACY – BUILT ON A FIRM FOUNDATION

Key Observations About Trinity:

- Trinity maintains a Christ-centered ministry to students
- Trinity students are academically successful
- Trinity has an excellent faculty and staff
- Trinity's sports, music, and drama programs are growing and excelling
- Trinity's financial support and donor base is increasing each year
- The community is excited about what is happening at Trinity
- Trinity is accredited through:
National Lutheran School Accreditation (NLSA), North Central Association
Commission on Accreditation (NCA), and the State of Indiana Department of
Education

Comparison Graph One from the State of Indiana Website

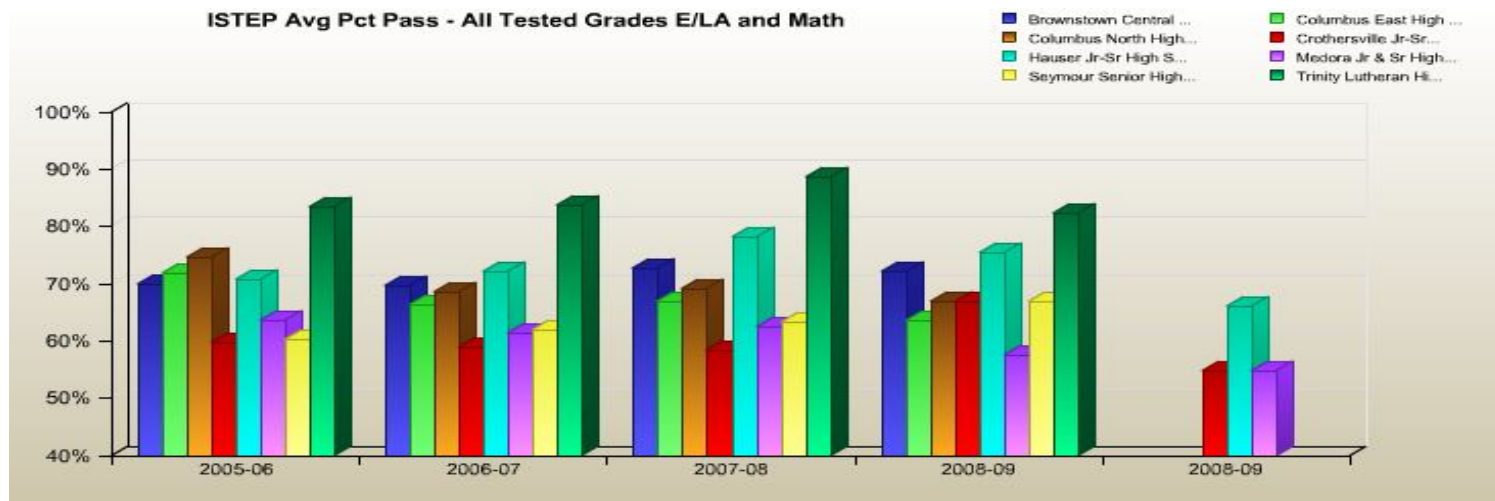

Comparison Graph Two from the State of Indiana Website

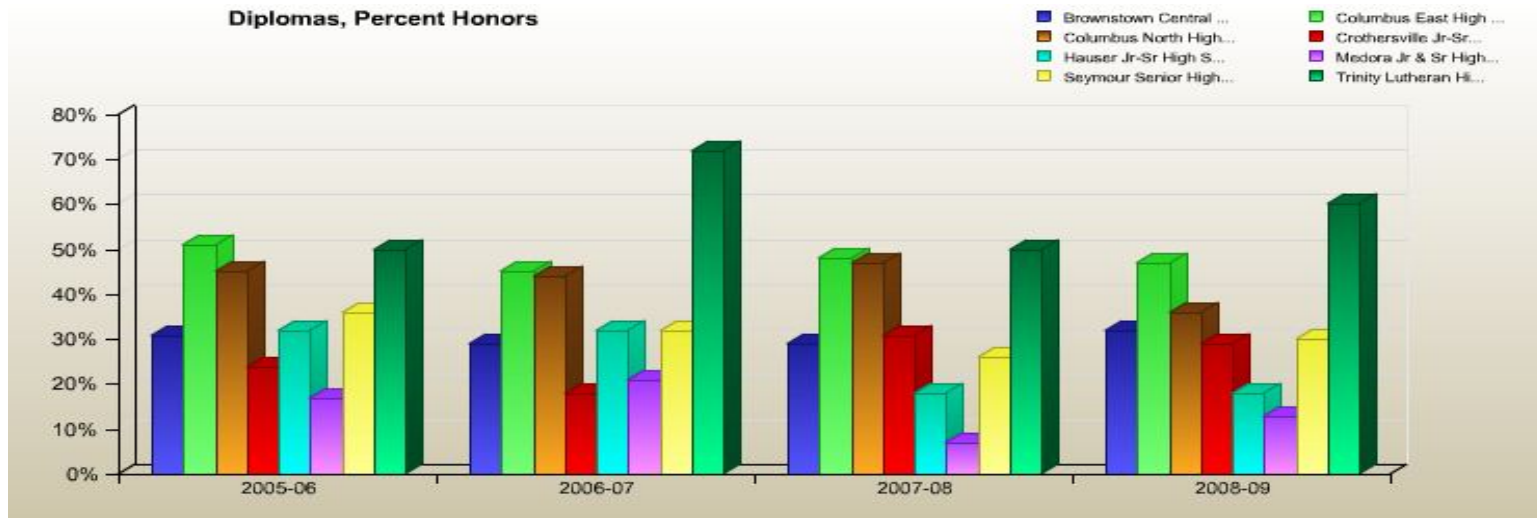

Comparison Graph Three from the State of Indiana Website

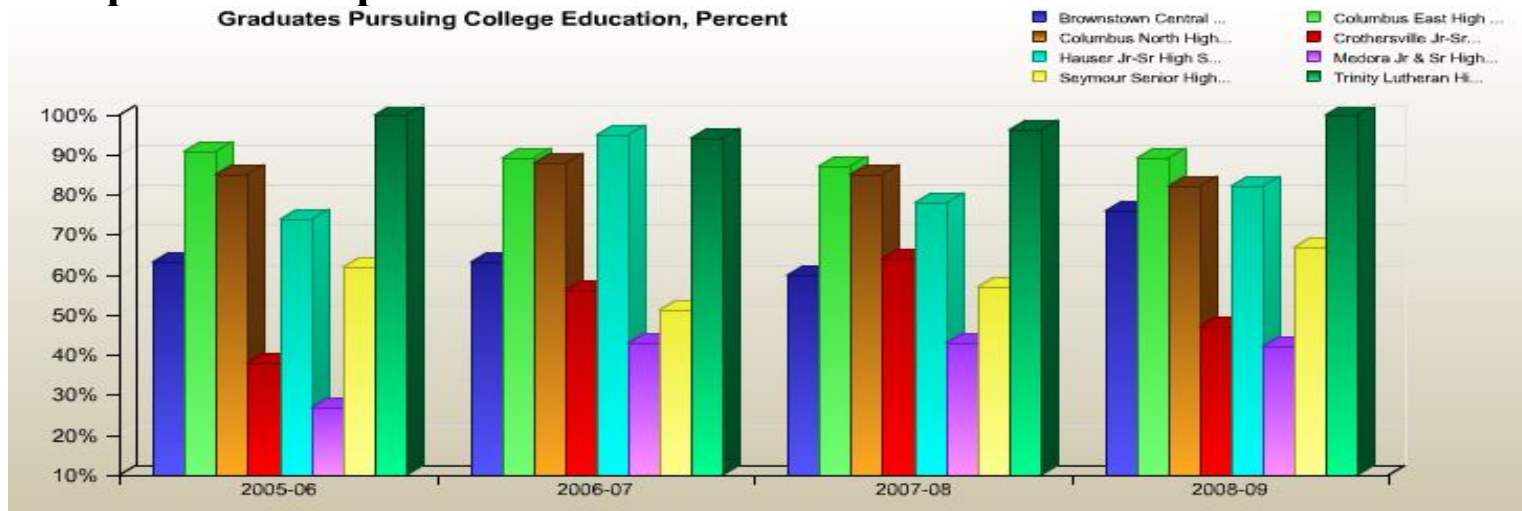

AT ISSUE:

Meeting the needs of a Growing Student Population

Long Term Projected Enrollment

Projected Enrollment:

Column A shows a four percent net increase per year following the current school year of 2010-11.

Column B shows a three percent net increase per year following the current school year of 2010-11.

Column C shows a two percent net increase per year following the current school year of 2010-11.

<u>Incoming School Year</u>	<u>Grade Year</u>	<u>A</u> 4 % increase	<u>B</u> 3% increase	<u>C</u> 2% increase
2009-2010	Last Year	135 students	135 students	135 students
2010-2011	Current	147 students	147 students	147 students
2011-2012	8 th	153 students	151 students	150 students
2012-2013	7 th	159 students	156 students	153 students
2013-2014	6 th	165 students	161 students	156 students
2014-2015	5 th	172 students	166 students	159 students
2015-2016	4 th	179 students	171 students	162 students
2016-2017	3 rd	186 students	176 students	165 students
2017-2018	2 nd	193 students	181 students	168 students
2018-2019	1 st	199 students	186 students	171 students
2019-2020	K	207 students	192 students	174 students

The response from parent surveys of parents with children in grades 6-8 in area Lutheran and Catholic schools, conducted in the summer of 2009, indicates Trinity should increase in enrollment to over 160 students by the fall of 2012. This is more than a four percent increase.

Our current facility will not support this number of students!

The Need:

An expanded facility will enable Trinity to continue to **Educate, Develop, and Prepare Christian Servants and Leaders.**

In the summer of 2009, we asked donors if they would support these projects with financial gifts: four classrooms, auditorium/chapel, tennis courts, girl's softball field, track & field, industrial arts room, and a football complex.

The **Need** graph asked donors to rate these projects by level of need, with rating A being the highest importance. The **Priorities** graph shows how donors rated what they believe to be the 1st, 2nd, and 3rd priorities of all the projects.

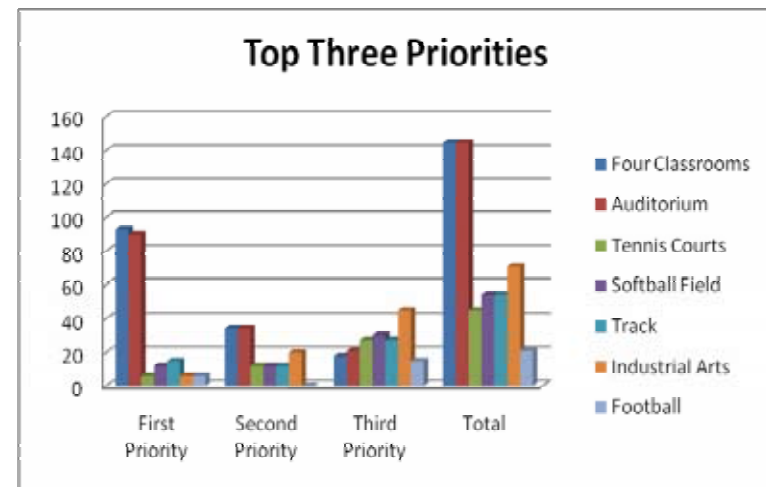
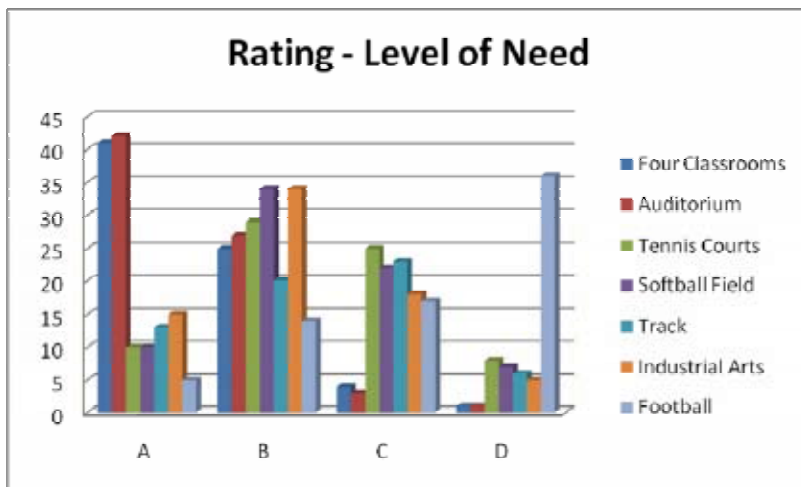

Conclusion: We believe this survey of donors showed significant support for facility expansion in two areas: four classrooms and an auditorium/chapel.

Proposed Solutions:

Phase 1

Building four additional classrooms by the fall of 2012 will meet the growing and projected student population. Classrooms will include a new art room, new band/choir room, and two instructional classrooms.



Phase 2

Building an auditorium will allow our drama and music programs to flourish, provide our students with a setting to better display their talents and gifts from God, and provide a beautiful and appropriate setting for our weekly chapel. It could also become a gathering focal point for our community of faith.

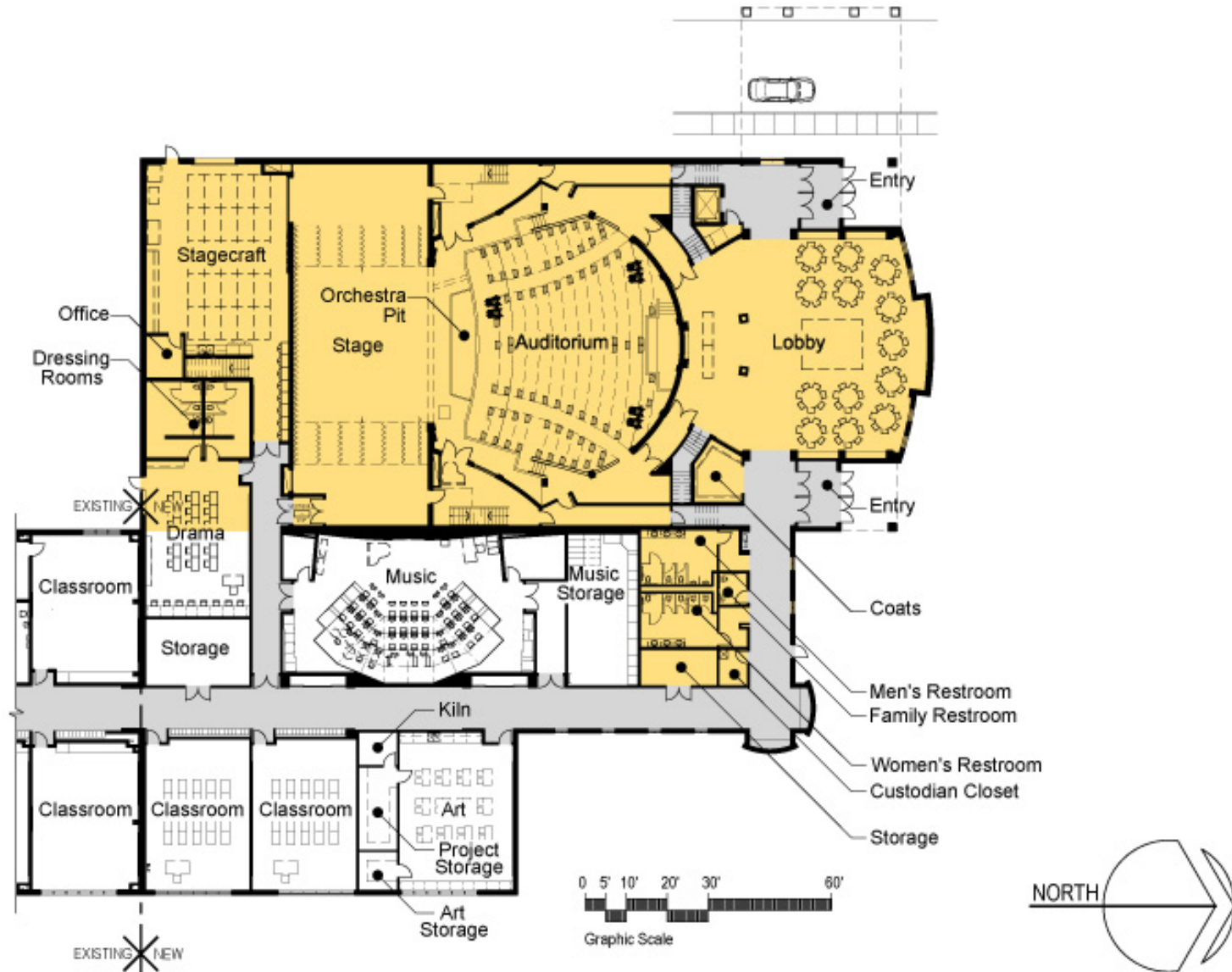

Phase 2 Continued

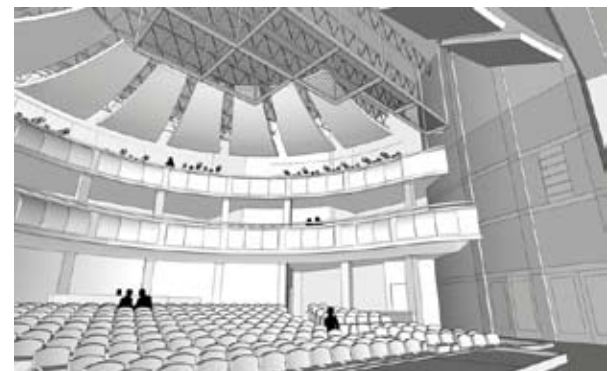
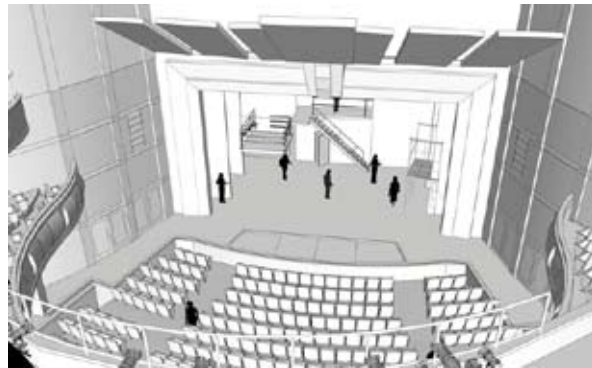
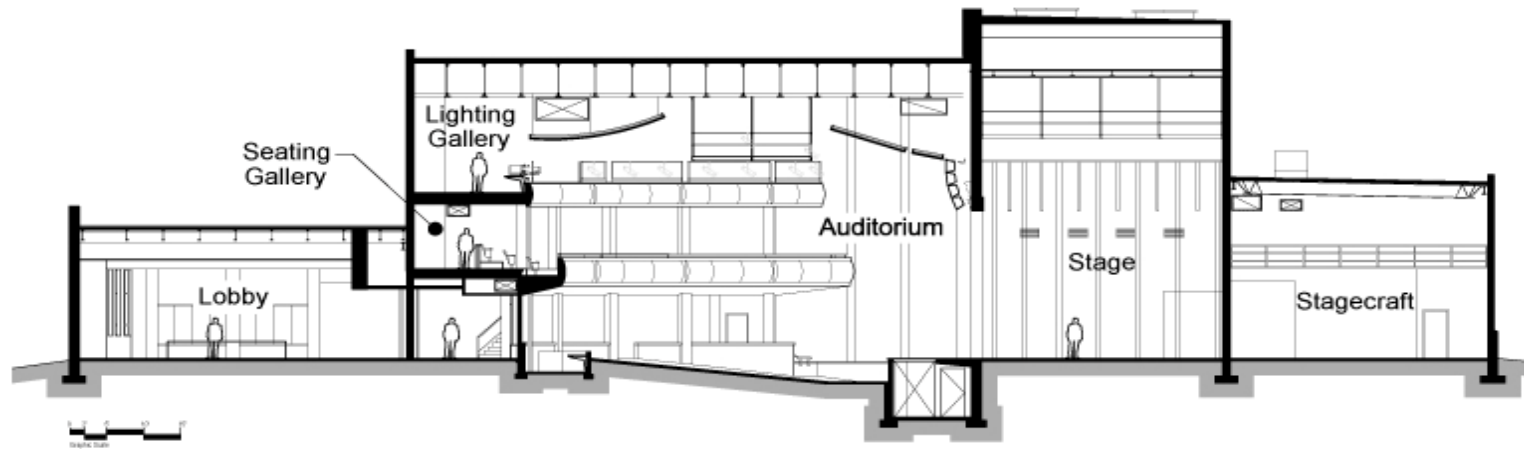

Phase 3

Building an addition to the gym will address current needs which include a new weight room area (This will free up additional classroom space.), a new concessions area, easily accessible public restrooms for outdoor events, and storage.



Site Plan For Entire Project



**LAYING A FIRM FOUNDATION FOR THE BENEFIT OF OUR
CHILDREN**

HELP TRINITY

**EDUCATE, DEVELOP, AND PREPARE
CHRISTIAN SERVANTS
AND
LEADERS**

